

By O.I. Black

State of South Carolina.
County of Greenville.

By request of J.M. Watson I have this day surveyed a tract of land which the above marks and boundaries doth represent. this March 3rd 1908.

J.A. Adams, Surveyor

Recorded 23. Jan. 1911.

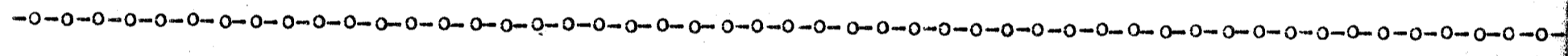

441

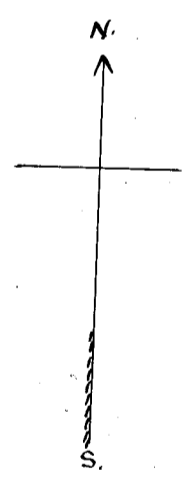
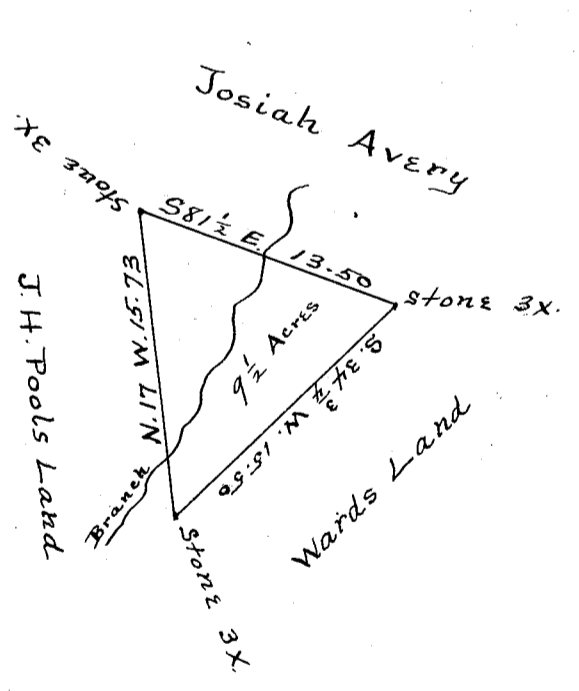

State of South Carolina,
County of Greenville.

I have this day surveyed a tract of land for Josiah Avery, which plat above marks, represents.

This the 3, of March 1908.

James Adams, Surveyor.

Recorded Feby. 1st, 1911

and platted by James R. Bates.